

GG GRAND JUNCTION®

High Profile Fifth Wheels



• Distinctive Style • First Class Elegance • Unsurpassed Value

Residential Features with Premium Components



34QRE in Pralines & Cream décor and Mesa Oak cabinetry shown with optional fireplace, "Ultra-leather" recliners, granite counter tops and 12 cu.ft. 4 door side-by-side refrigerator.



GRAND JUNCTION

Step into *Grand Junction* and experience the ultimate in sophistication and luxury, featuring arched, glazed hardwood cabinet doors and frames, solid surface counter tops and residential furnishings.

Grand Junction is the new standard in style, features and function.

All *Grand Junction* models feature solid hardwood doors and cabinet stiles (frames)*.

*See page 4 Competitive Advantages for details.



Grand Junction solid wood cabinetry is available in two glazed, stained finishes oak or cherry.



Mesa Oak



Canyon Cherry
(Optional)

MOR/Ryde Suspension System



Grand Junction provides the MOR/Ryde Equalizer Suspension System and Rubber Shear-Spring Pin Box as standard features. The systems work in unison to create the smoothest ride possible in a fifth wheel.

The MOR/Ryde suspension system uses rubber shear springs that work in concert with the steel leaf springs. The rubber shear spring replaces the leaf spring equalizer. The MOR/Ryde system will lower the spring rate providing

for almost double the axle travel of traditional systems. Increased axle travel translates into a smoother ride which protects your RV from jarring caused by rough roads.

The MOR/Ryde Rubber Shear-Spring Pin Box incorporates a rubber shear spring that works both longitudinally and



laterally to diminish the back and forth 'chucking' motion that occurs between the tow vehicle and RV. This means a more comfortable ride for the driver and passengers. Plus, it reduces stress on the fifth wheel frame and helps prevent damage that can occur from rough towing.



MOR/Ryde Equalizer

Competitor's Equalizer

The Competition

Most competitors still use a steel pivoting equalizer and standard pin box which **does not** provide the level of shock absorption and damage protection of the MOR/Ryde system.

Protect your investment and enjoy the ride the with MOR/Ryde system.



Competitor's Hitch

6-Way Welded Aluminum Cage Construction

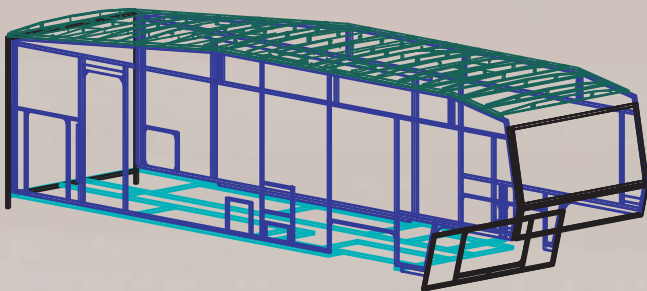

Insulation "R" Values

Roof	R21	Floor	R17
Sidewalls	R9	Front/Rear Wall	R9

R21, 5-Layer Roof Construction

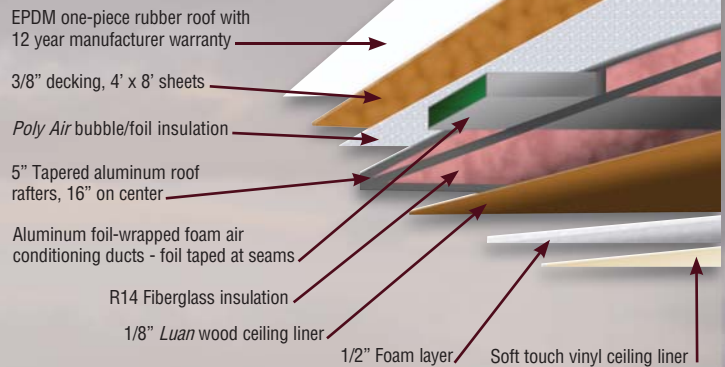

Vacuum-Bonded Laminated Wall Construction

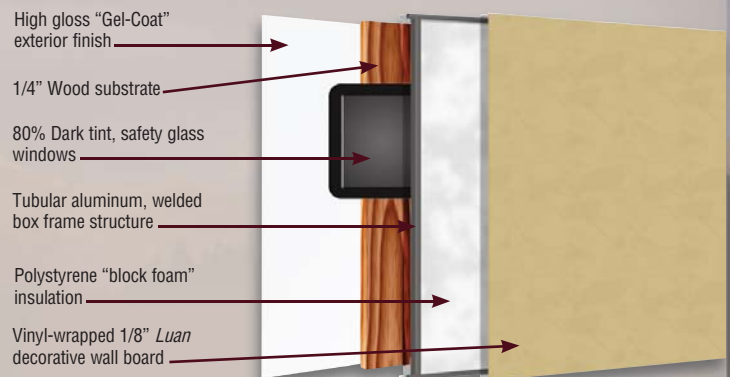

Laminated Floor Construction

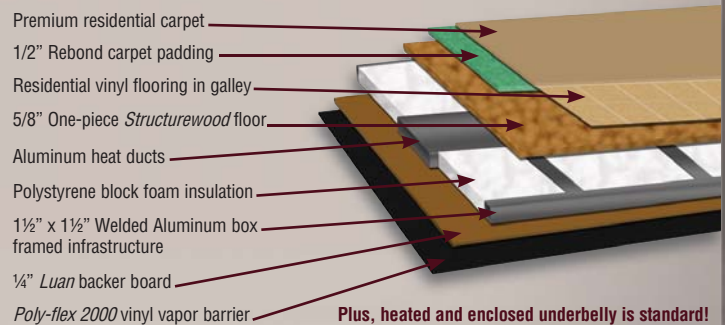

Heated/Enclosed & Insulated Underbelly

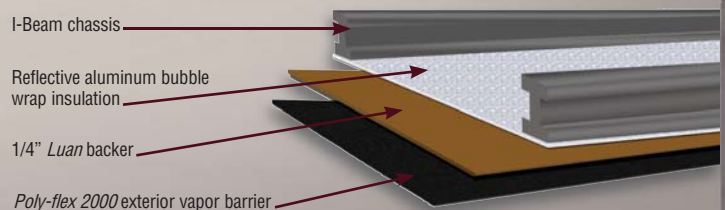

Competitive Advantages

Grand Junction's Stacked Rail Chassis Design



Grand Junction prides itself on having the best storage system possible in a fifth wheel.

That's why we use a stacked rail chassis design. This chassis

design uses double I-beam frame rails to increase the amount of storage space under the bath/bedroom deck. Many models feature an amazing 125 cubic feet of storage – almost 60% more than the competition!

Plus the design of the frame includes a wide stance front jack system. The jacks are placed almost 9" further apart than the competition which increases stability and prevents unwanted body movement when parked.

The Competition

The competition still uses the traditional straight rail fifth wheel chassis that restricts storage space. Their jacks are mounted closer to the center of the chassis making it less stable.



Grand Junction - superior storage and stability

6'7" Bedroom Height at Front Cabinet



More space in the bedroom includes more headroom too! *Grand Junction's* front wall and roof line allows for added headroom in the bedroom - a full 6' 7" tall at the front storage cabinet!

Most competitors' headroom decreases from the center of the bedroom to the front wall. Some are as low as 5'8" tall.

Grand Junction - more storage, more height, more comfort

Solid Hardwood Doors & Cabinets



Grand Junction's Hardwood Stiles, Slot & Screw Construction



Competitors Lumbercore Stiles, Staple Construction

Grand Junction features solid ash cabinet stiles/frame, hardwood cabinet doors, drawers and slide room fascias. The wood is stained to match the solid hardwood cabinet stiles.

Many competitors use less expensive, vinyl wrapped MDF fiberboard or lumbercore stiles and slide room fascias. Additionally, many add veneer inserts to their doors and vinyl wrap their stiles to reduce cost.

Hardwood doors, stiles and fascias will retain their factory new appearance for years. The competitions less expensive construction may swell and delaminate over time.

Grand Junction - which would you rather own, real or made to look real?

Soft Touch Ceiling Liner



Attention to detail makes all the difference when you are choosing your next recreational vehicle. On top of all of the other features that make *Grand Junction* special, we have even looked at ways to improve the ceiling liner.

Grand Junction includes a soft-touch ceiling liner. Usually only found in high end motor homes, *Grand Junction* includes this feature as a standard item.

The soft-touch ceiling liner is stylish vinyl layer that is laminated to 1/2" foam and a 1/8" wood backer. The ceiling liner has a great look, plus it reduces sound levels and adds another layer of insulation to your fifth wheel.

The competition uses a white panel board with nailed batten strips at the seams – every 4'. Ceiling paneling may work loose over time and does not provide the look or insulation value *Grand Junction's* soft touch ceiling provides.

Grand Junction - you can see, feel and hear the difference!

Entry Steps



Grand Junction's XL, 10" Deep Entry Steps



Competitors 8" Deep Steps

Grand Junction's entry steps are a full 10" deep and include two anti-slip strips per step. Plus the corners are rounded for added safety.

Most competitors use only 8" deep, square corner steps.

Your safety is important to *Grand Junction*.

Grand Junction - designed for safety

Steel Ball Bearing Drawer Glides



Grand Junction's stainless steel ball bearing drawer hardware is designed for years of rigorous use. The drawer glides are designed to open easily under a full load and include a drawer stop feature to prevent drawers from opening during travel. The hardware is mounted on the sides of the drawers and is screwed to solid wood drawer sides.

Many competitors use single plastic or combination plastic and metal drawer glides mounted on the bottom of the drawer. Check out the competitions drawer sides. – Are they real wood?

Grand Junction - premium, quality features



Premium Appliances & Utilities

Heating and Cooling Systems

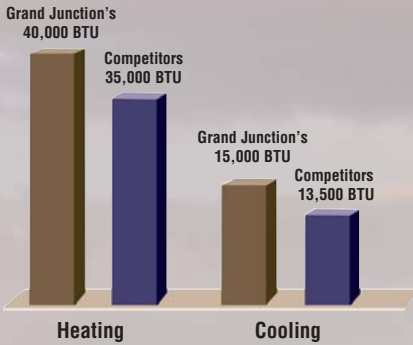

Heating: *Grand Junction* will keep you warm on those chilly evenings with a standard 40,000 BTU forced air furnace. Most competitors only offer a 35,000 BTU furnace.

Cooling: *Grand Junction* features a standard 15,000 BTU roof air conditioner with a quick cool feature. It's easy to use and cools your RV more efficiently than the competitions 13,500 BTU roof air.

Grand Junction - warmer, cooler – better!

12 Gal. Water Heater

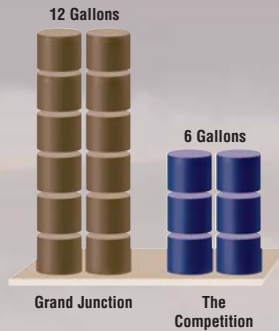

Grand Junction's standard 12 gallon, quick recovery water heater allows for longer showers.

Don't settle for the competition's smaller 6 or 10 gallon water heater.

Large Fresh Water & Waste Water Tanks

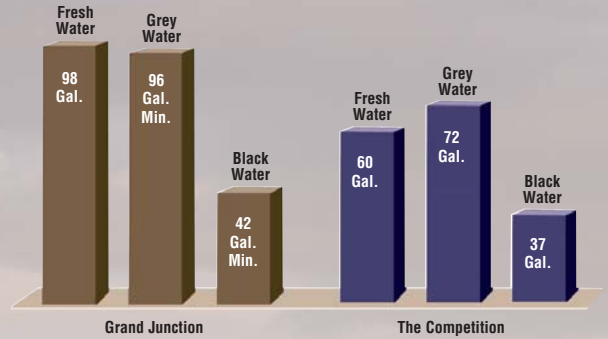

Anyone who has owned RV's in the past knows that large tank sizes are critical. That's why *Grand Junction* uses a 98 gallon fresh water tank, 42 gallon black water tank and dual 48 gallon grey water tanks – some models even feature a third 48 gallon grey water tank!

Add *Grand Junction's* standard 12 gallon hot water heater to the equation and you will find that the *Grand Junction* has one of the largest water storage systems available in the market today. (See model information for specific tanks sizes)

40% more Fresh Water capacity – 20% more Black Water capacity and 20% more Grey Water Capacity – The Grand Junction Advantage

Sealed Burner Oven & Half-Time Convection Microwave

Grand Junction is designed for enhanced livability by providing you with the industry's most advanced products as standard features. Our 22" *Amana* oven is larger than most competitors' 19" oven, plus the 3-burner cook top features a sealed burner with wire pan rack and range cover.

Grand Junction also features a large 1.3 cu.ft. *Half-Time* convection microwave that operates like a standard microwave or convection oven. Both features can be used together to greatly reduce cooking time. More importantly, the microwave is a residential-style "over the range" appliance with an integrated exhaust fan that is vented to the outside.

Many competitors use a 19" oven with an open burner cook top. These conventional cook tops have openings that allow food and crumbs to fall between the top and the oven, making them difficult to clean. Plus, the competition uses a 1 cu.ft. microwave that is built into the overhead cabinets and requires a separate exhaust fan that robs your galley of usable space, lifting the appliance to a height that is uncomfortable and dangerous for most users.

Premium appliances - enhanced livability



Solid Surface Residential Counter Tops

Nothing says class and elegance in a kitchen like solid surface counter tops. *Grand Junction's* solid surface counter tops are the ultimate in style and function. Each counter top is 1/2" thick and is handmade to fit your vehicle to assure many years of durable use and classic beauty.

Grand Junction is also available with optional granite counter tops for added elegance.

Many competitors use laminate counter tops that are glued to 1/4" particleboard backers or a fiberglass base with 1/16" of sprayed acrylic. Try running your fingers along the edge, be careful!

Which type of countertop would you rather have?



Standard Solid Surface Countertops



Optional Granite Countertops

Premium Residential Lighting

Grand Junction features premium residential lighting as a standard feature. From the oil-rubbed bronze dual pendant dinette light to the standard reading lamps and fluorescent lighting in the galley, *Grand Junction* provides stylish lighting that you need after dark. Plus, *Grand Junction* features "puck style" recessed halogen lights. This new innovation spreads even amounts of natural daylight-style lighting throughout your coach. You will love the glow of these lights.

Don't settle for the competition's old fashioned "pancake" lights!



Décor Choices

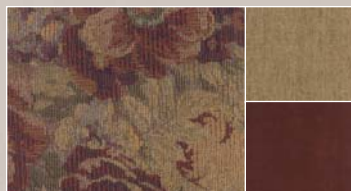

Cranberry Compote



Pralines & Cream



Mocha Latte



Rum Raisin

Premium Floorplans and Specifications

335TRL

Unloaded Vehicle Weight	11,899
Dry Hitch Weight	2,231
Gross Vehicle Weight	15,500
Net Cargo Capacity	3,601
Length	36' 7"
Exterior Width	8'
Exterior Height*	12' 9"
Fresh Water Capacity	98
Grey Water Capacity	48/48
Black Water Capacity	48
Tire Size	ST235/85R16 (E)
Furnace Size (BTU's)	40,000

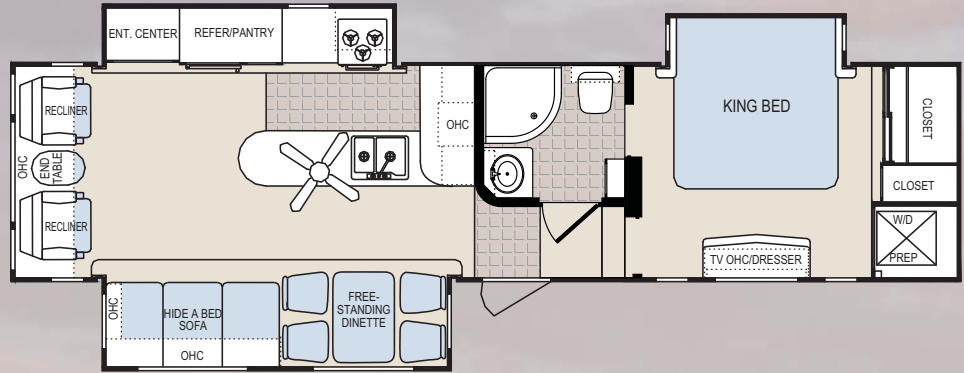

340RE

Unloaded Vehicle Weight	12,246
Dry Hitch Weight	2,472
Gross Vehicle Weight	15,500
Net Cargo Capacity	2,782
Length	38' 10"
Exterior Width	8'
Exterior Height*	12' 7"
Fresh Water Capacity	98
Grey Water Capacity	48/66
Black Water Capacity	48
Tire Size	ST235/85R16 (E)
Furnace Size (BTU's)	40,000

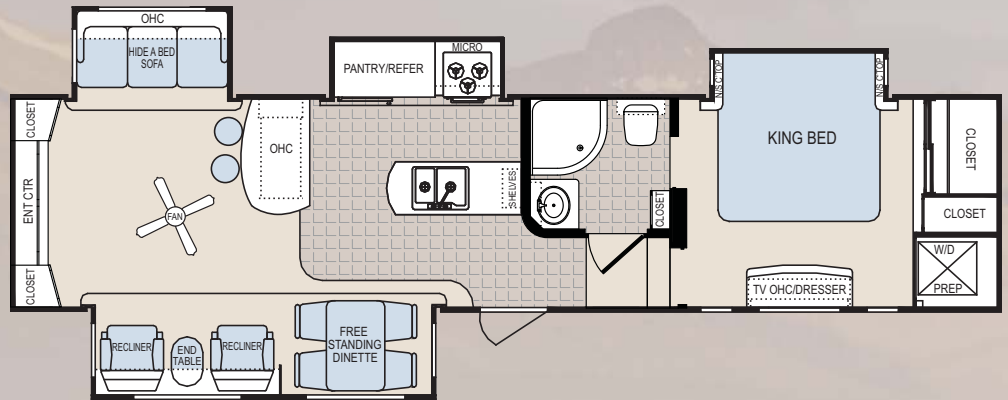

340RL

Unloaded Vehicle Weight	12,826
Dry Hitch Weight	2,613
Gross Vehicle Weight	15,500
Net Cargo Capacity	2,674
Length	38' 3"
Exterior Width	8'
Exterior Height*	12' 8"
Fresh Water Capacity	98
Grey Water Capacity	48/48
Black Water Capacity	42
Tire Size	ST235/85R16 (E)
Furnace Size (BTU's)	40,000

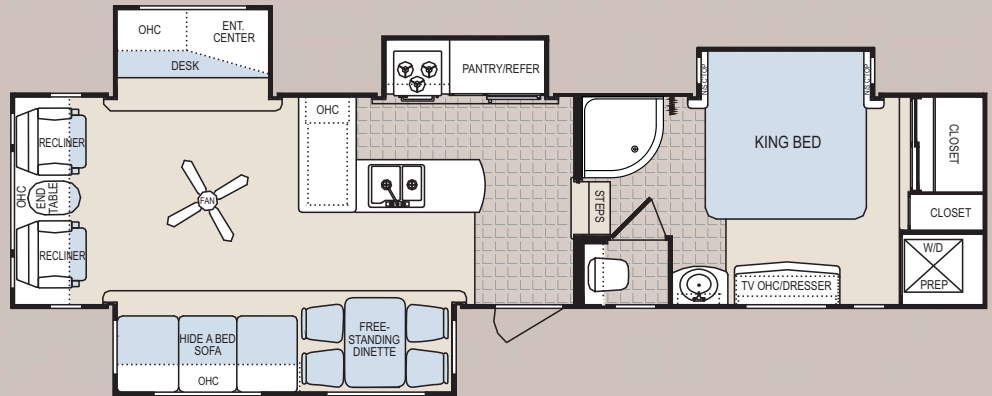

34TRG

Unloaded Vehicle Weight	12,318
Dry Hitch Weight	2,870
Gross Vehicle Weight	15,500
Net Cargo Capacity	3,182
Length	38' 4"
Exterior Width	8'
Exterior Height*	12' 8"
Fresh Water Capacity	98
Grey Water Capacity	48/48/48
Black Water Capacity	48
Tire Size	ST235/85R16 (E)
Furnace Size (BTU's)	40,000

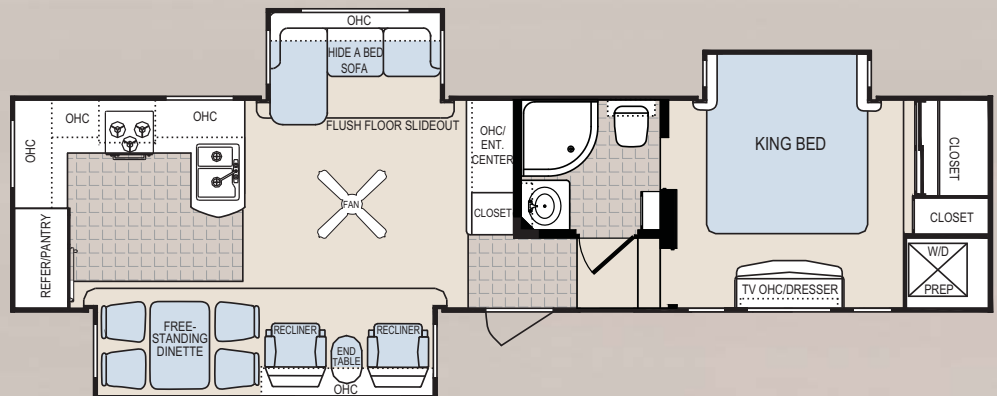

35TMS

Unloaded Vehicle Weight	12,840
Dry Hitch Weight	2,273
Gross Vehicle Weight	15,500
Net Cargo Capacity	2,660
Length	39' 8"
Exterior Width	8'
Exterior Height*	12' 8"
Fresh Water Capacity	98
Grey Water Capacity	48/66
Black Water Capacity	42
Tire Size	ST235/85R16 (E)
Furnace Size (BTU's)	40,000

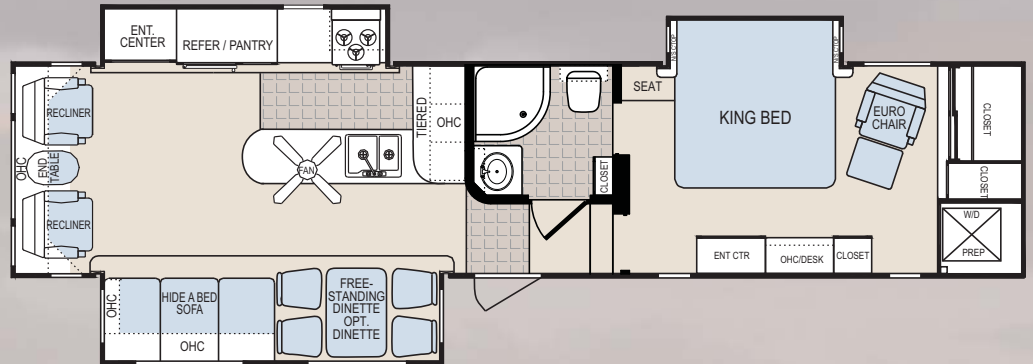

37QSB

Unloaded Vehicle Weight	13,199
Dry Hitch Weight	2,442
Gross Vehicle Weight	15,500
Net Cargo Capacity	2,302
Length	40'
Exterior Width	8'
Exterior Height*	12' 9"
Fresh Water Capacity	98
Grey Water Capacity	48/48
Black Water Capacity	42
Tire Size	ST235/85R16 (E)
Furnace Size (BTU's)	40,000

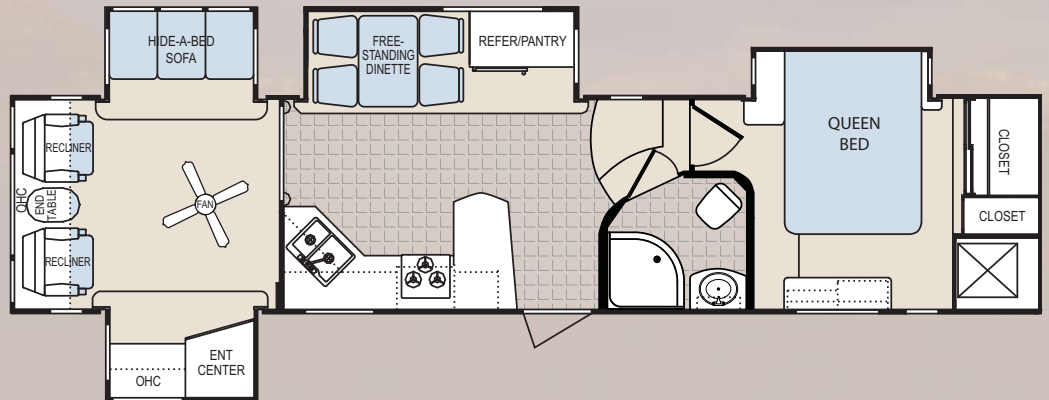

37QSL

Unloaded Vehicle Weight	13,060
Dry Hitch Weight	2,472
Gross Vehicle Weight	15,500
Net Cargo Capacity	2,440
Length	40'
Exterior Width	8'
Exterior Height*	12' 9"
Fresh Water Capacity	98
Grey Water Capacity	48/48
Black Water Capacity	42
Tire Size	ST235/85R16 (E)
Furnace Size (BTU's)	40,000

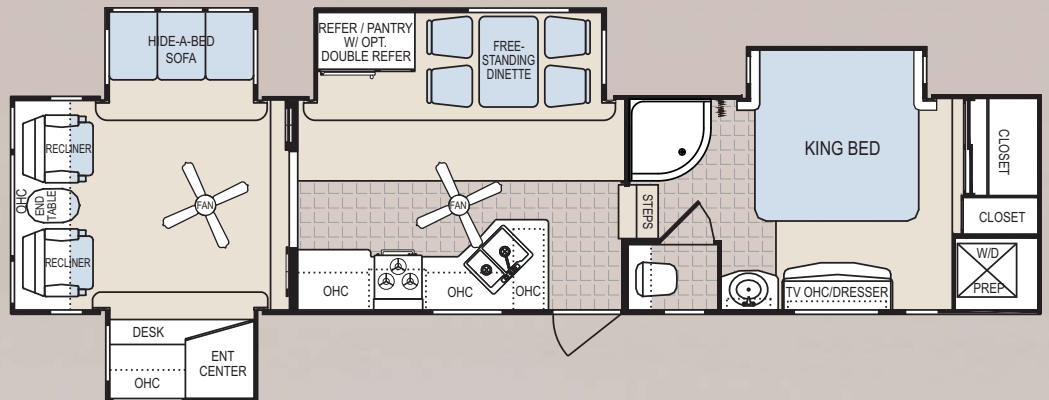



More Standard Features – More Value

Frame/Chassis Construction

Cambered 10" Steel I-Beam Frame Rails
 Drop-Frame, Stacked Rail Chassis *
 Extended Heavy Duty Hitch
 Wide Stance Electric Front Jacks
 Side Mounted Dual Battery Trays
 Recessed Under-Chassis Spare Tire Carrier (NA 34QRE)
 MAXXGarage Storage Design
 Powder-Coated Frame
 10" Steel Crossbeams
 "Ladder Design" Construction
 Steel Outriggers
 7000 lb. Tandem Axles ****
 Leaf-Spring Suspension
 MOR/*ryde* RE Rubber Shear Spring Equalizer ****
 8 Lug Ultra-lube Hubs ****
 ST235/80R16 LRE E-Rated Tires with Aluminum Alloy Rims ****
 Electric 12.25" Drum Braking System
 MOR/*ryde* Rubber Hitch Pin ****

Slide Room

Above Floor Electric "Worm Gear" Slide System (Based on Floorplan)
 Above Floor Electric Bedroom Slide

Body/Coach Construction

Sidewalls

Gel-Coat High Gloss Exterior with 3M Automotive Graphics ***
 Vacuum-Bonded Lamination Process
 Aluminum-Framed, Welded Box Infrastructure
 Polystyrene "Block Foam" Insulation
 Vinyl-Wrapped Luan Interior Wall Panel
 80% Tinted, Radius-Corner, "Safety Glass," UV-Rated Windows

Front & Rear Walls

Front Cap & Rear Cap: Gel-Coat Molded Fiberglass
 Aluminum-Framed, Welded Box Infrastructure
 Laminated Construction
 80% Tinted, Radius-Corner, "Safety Glass," UV-Rated Windows
 Polystyrene "Block Foam" Insulation
 Vinyl-Wrapped Luan Interior Wall Panel

Primary Floor

3" Vacuum-Bonded, One-Piece Floor
 Aluminum-Framed, Welded Box Infrastructure
 Polystyrene "Block Foam" Insulation
 1/4" Luan Panel
 Vinyl Vapor Barrier
 5/8" *Structurewood* One-Piece Decking
 1/2" 6 lb. Rebond Carpet Pad with Premium Residential Carpet **

Bath/Bedroom Floor

3" Vacuum-Bonded, One-Piece Floor
 Aluminum-Framed, Welded Box Infrastructure
 Polystyrene "Block Foam" Insulation
 1/4" Luan Panel
 5/8" *Structurewood* One-Piece Decking
 Premium Residential Carpet

Sub-Floor/Underbelly *

Laminated Construction - 2 Piece Application
Polyflex 2000 Exterior Vapor Barrier Applied to .25" Luan Substrate
 "Reflectex" Aluminum Bubble Wrap Insulation (R7)

Roof/Ceiling

Aluminum Roof Truss with 5" Tapered Box
 3/8" Roof Decking
 R21 Roof Insulation **

Radius Aluminum Roof to Wall Transition
 EPDM Rubber Roof Membrane-12 Year Warranty

Storage Compartment

MAXXGarage Storage Area
 Aluminum Luggage Door Frames
 1" Thick Luggage Door with Lock
 Lighted Baggage Areas/110V Electrical Outlet
 ABS Floor Deck, Diamond Pattern, Non-Skid Surface

Windows, Doors and Awnings

80% Tinted, Radius-Corner, "Safety Glass," UV-Rated Windows
 Transom Window Above Main Slide ***
 Vented Windows (NA Transom Window)
 Egress Window in Bedroom
 Domed Tinted Skylight Above Shower
 30" Radius-Corner Entry Door with Dead Bolt Lock
 Screen Door
 Power Electric Awning **
 Pivoting, XL Entry-Assist Handle *
 Optional: *Duo-Pane* Windows
 Optional: Slide-Out Awning Toppers

Exterior Features

"Draw Tight" Rear Electric Stabilizer Jack ***
 Wide Stance Electric Front Jacks with Quick Release Pull Pin *
 16" Steel Rim Spare Tire and Carrier with Lift Kit ****
 Underbelly (2 piece) - Heated & Enclosed *
 Lighted, 10" Deep, Steel, Triple-Entry Steps - Frame Welded *
 Enclosed/Vented Battery Compartment for Dual Battery
 Molded ABS Fender Wells
 Exterior Patio Light *
 Exterior Hitch Light
 Exterior Utility Station ***
 Gravity Water Fill
 Exterior Hot & Cold Shower System **
 Black Tank Flush System *
 City Water Fill with Locking Protective Door
 Utility Light *
 Cable and Phone Hook-ups
 Satellite Prep *
 Rear Ladder ***
 Attic Roof Vents (2) *
 Drip-Rail Gutter System with Extended Gutter Spout

Interior Systems

Electrical Systems & Lighting

Centralized Interior Electrical Command Center
 50 Amp Electrical Service
 Detachable Marine-Grade Power Cord **
 75 Amp Converter *
 Battery Disconnect
 110v GFI Exterior Receptacle
 12v Battery Converter/Charger with Overcharge Protection
 Dual Battery Configuration *
 Residential Wall Switches and Dimmer Switches
 Dome Pendant Light Above Dinette & Dome Light Above Sofa
 Recessed Halogen Puck Lighting ***
 Decorative Wall Scones in Living Room and Bedroom
 Fluorescent Lighting in Galley and Desk Areas *
 Optional: Generator Prep
 Optional: *Onan Marquis Gold* 5.5 kw LP Generator

Plumbing System

12 Gallon Gas and Electric Hot Water Heater ***
 Quick Disconnect, Coiled, 25ft. Hose with Sprayer

Shurflo Water Pump
 "PEX" Polyethylene Tubing and Metal Pressure Fittings
 Sewer Hose Storage System
 Hot and Cold Water, Low Point Drains
 98 Gallon Fresh Water Tank with 1.5" Gate Valve Drain ***
 Grey Water Tank: See Individual Floorplan Specs for Details
 Black Water Tank: See Individual Floorplan Specs for Details
 Remote Water Heater Switch
 Washer/Dryer Prep (Stackable Capability) ***

Climate Control

40K BTU Furnace ***
 Forced Air Ducted Heat and Forced Air Heat in Underbelly
 15K BTU Air Conditioner with Quick-Cool Vent ***
 Ceiling-Ducted AC Vents
 42" Reversible Ceiling Fan with Light Kit *
 Mold-Resistant, Aluminum-Wrapped AC Plenum
 Pre-Wired and Prepped for 2nd AC *
 Optional: Dual (2) Low Profile AC with Heat Pumps
 Optional: Low Profile 13.5K BTU Bedroom AC-Direct Feed
 Optional: *Fantastic* Fan in Bedroom (NA with Dual AC)
 Optional: *Fantastic* Fan in Galley/Main Living Area
 Optional: Electric Fireplace with 4K BTU Heater
 Optional: 12 V. Tank Pads (NA with CSA)

Key Interior Features

Vinyl "Soft Touch" Padded Ceiling ***
 Pre-Drilled & Screwed, Stained Ash Cabinet Construction
 Decorative, Stained Ash Slideout Fascia **
 6 Panel Doors with Designer Oil-Rubbed Bronze Hardware **
 1/2" 6 lb. Rebond Carpet Pad with Premium Residential Carpet **
 Overhead Cabinets with Mini-Struts & Top Mount Hinges
 Minimum Ceiling Height 6' 7" in Bedroom

Cabinetry & Countertops

Solid Surface Acrylic Countertops **
 Solid Ash, Stained Cabinet Siles/Frames **
 Solid Ash, Glazed Drawer Fronts and Raised Panel Cabinet Doors
 7-Ply Residential-Grade Plywood Drawer Construction
 Stainless Steel, Ball-Bearing Drawer Glides with Adjustable
 Drawer Latch **
 Ball-Bearing Slide-Out Pantry ***
 Oil-Rubbed Bronze Hardware *
 Stained Glass Inserts with Glazed Ash Curio Frames Above Sofa
 Optional: Granite Countertops
 Optional: Cherry Stained, Glazed Hardwood Cabinetry

Window Treatments

Day/Night Shades ***
 Mini-Blinds (At Kitchen Sink Window)
 Designer Hard Valance

Entertainment Systems

32" LCD HD TV ***
 5-in-1 Home Theater System with Remote ***
 Satellite Prep *
 Cable Jack and TV Antenna with Power Booster
 Bedroom TV Prep
 Optional: 19" LCD TV with DVD in Bedroom

Galley Area

Residential Tile-Like Linoleum with "Tough Guard"
 Deep, Residential-Style Double-Bowl Sink
 High-Profile Faucet with Retractable Sprayer
 Sink Covers
 Ball-Bearing Slide-Out Pantry ***
 Cabinet Doors on Both Sides of Galley Cabinets (See Floorplan)

Furniture & Appliances

Hide-A-Bed Sofa ***
 End Table with Lamp ***
 Dual Recliners ***
 Free-Standing, Sliding-Top Dinette Table with Flip-Up Storage **
 Two Designer Dinette Chairs with Below-Seat Storage **
 Two Coordinating Folding Dinette Chairs **
 Premium King or Queen Size Pillow-Top Mattress ***
 8 cu.ft. Double Door Refrigerator *
 Solid Ash, Glazed, Raised Panel Refrigerator Inserts *
 Large 1.3 cu.ft. Convection "Over-the-Range" Microwave
 with Integrated Exhaust Fan ***
Amana Sealed 3-Burner Stove with 2 Piece Metal Cover ***
 All Coach Water Filtration System *
 Interior Utility Center
 Central Vacuum System **
 Optional: 10 cu.ft. Refrigerator
 Optional: 12 cu.ft. 4 Door Side-by-Side Refrigerator
 Optional: 2 "Ultra Leather" Recliners
 Optional: Ottoman with Storage

Bath Area

One-Piece Rounded Fiberglass Shower with Seat **
 Radius Rain-Glass Shower Walls & Door
 Oil-Rubbed Bronze Shower Hardware and Wand
 Large Medicine Cabinet with Vanity Lights & Mirror
 Fiberglass Vanity Sink with Residential-Style Faucet
Thetford Porcelain Bowl Toilet ***
 Power Vent
 Toilet Tissue Holder
 Oil-Rubbed Bronze Bathroom Hardware
 Towel Hooks and Towel Bar

Bedroom Area

Solid Hardwood, Stained Headboard **
 Night Stands
 Dresser with Overhead Cabinet and TV Prep
 Egress Window
 Solid Wood Window Box with Mirrored Doors
 Premium Bedspread Package & Window Coverings
 Below Bed Storage
 Front Wardrobe Ensemble
 Sliding Mirrored Doors with Hanging Storage & Shelf
 Drawer Bank with Clothes Hamper
 Washer/Dryer Prep Behind Louvered Doors with Rod
 & Shelves ***
 Optional: *Select Comfort Sleep* Number Bed

Safety Features

Fire Extinguisher
 Dead Bolt Locks on Entry Doors
 120V GFI Protected Exterior Receptacles
 LP Gas and Smoke Detectors
 Egress Windows
 Safety Glass Windows
 Lighted, 10" Deep, Steel, Triple-Entry Steps - Frame Welded *
 Patio Light *
 Pivoting, XL Entry-Assist Handle *
 Interior, Solid Wood Exit Handle
 Rear Radius Automotive Lamps
 Front, Rear & Side Amber Road Lights

* *Grand Junction* Value Package
 ** *Grand Junction* Mile High Premiere Package
 *** *Grand Junction* Easy Living Premium Package
 **** *Grand Junction* Touring Performance Package

2164 Caragana Court • Goshen, IN 46526 • Sales: 574-534-1224 • Fax: 574-975-0601 • Parts, Service & Warranty: 574-537-0700

www.GrandJunction-rv.com

Limited Warranty • Two years structural and appliance • One year hitch to bumper • See owners manual for more information

Vehicle loading - Every effort has been made to provide the greatest number of options for the recreational vehicle owner. Along with these choices comes the responsibility to manage the loads that are imposed by the choices that they remain within the manufacturer's specified chassis weight limits. Do not overload the recreational vehicle.
 Some optional equipment not included. Net carrying capacity (NCC) is determined by subtracting unloaded vehicle weight (UVW) from gross vehicle weight (GVWR) and includes fluids, options and cargo. Liquid capacities and weights are approximations only. Warning - This information is intended as a guide only. Weights of individual vehicles may vary. Consult your owner's manual for complete loading, weighing and towing instructions. *UVW and Hitch Dry Weight are base weights of units without options. Each unit includes a weight label which lists specific weight information for that unit.
 Product information, specifications, and photography in this brochure were as accurate as possible at time of printing. Photographs may contain some features that are optional on your vehicle. Since we continually strive to improve our products, actual products may differ. Prices and specifications are subject to change without notice. All capacities are approximate and dimensions are nominal. Some features or options may be different or unavailable in Canada. Vehicles are designed for recreational use only and not intended for use as a primary residence. All product brand names used in this brochure are registered trademarks of Thor Industries Inc. Unauthorized use of trademarks is prohibited by law.

YOUR LOCAL DEALER